

HOLUND

HOLUND ELEKTRONIKK AS

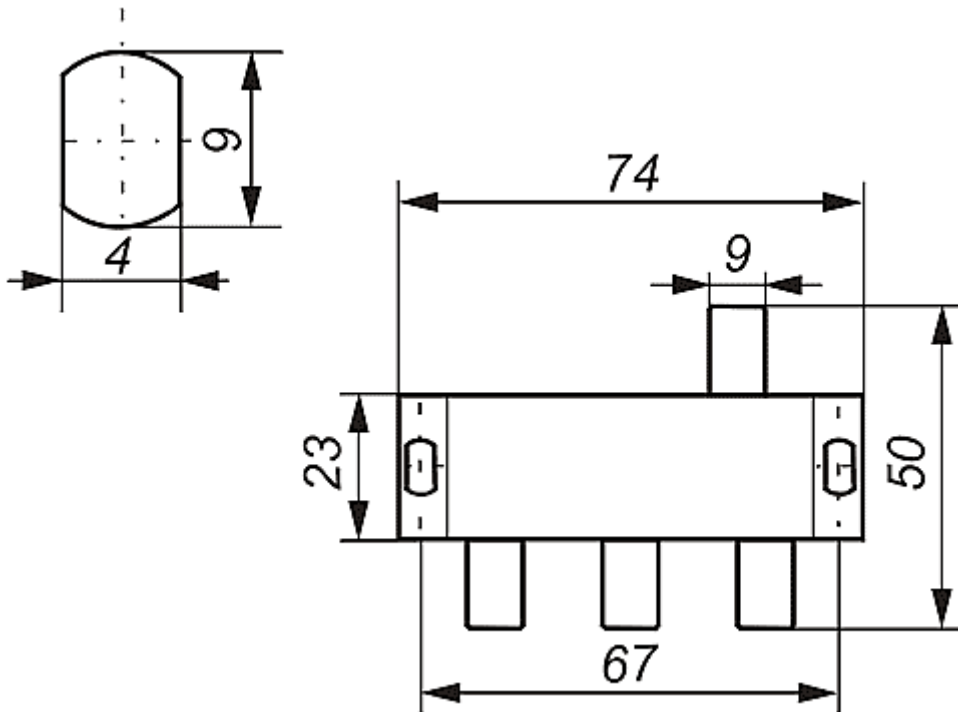

Dimensions [mm]

The splitter is CE certified. Its operating frequency range is 5-1000 MHz and the product represents good, standard parameters within its class. It is equipped with F connectors and cast aluminum housing.

Specification

Name	Signal R-3
Code	207-958
Number of outputs	3
VHF loss [dB]	5,2

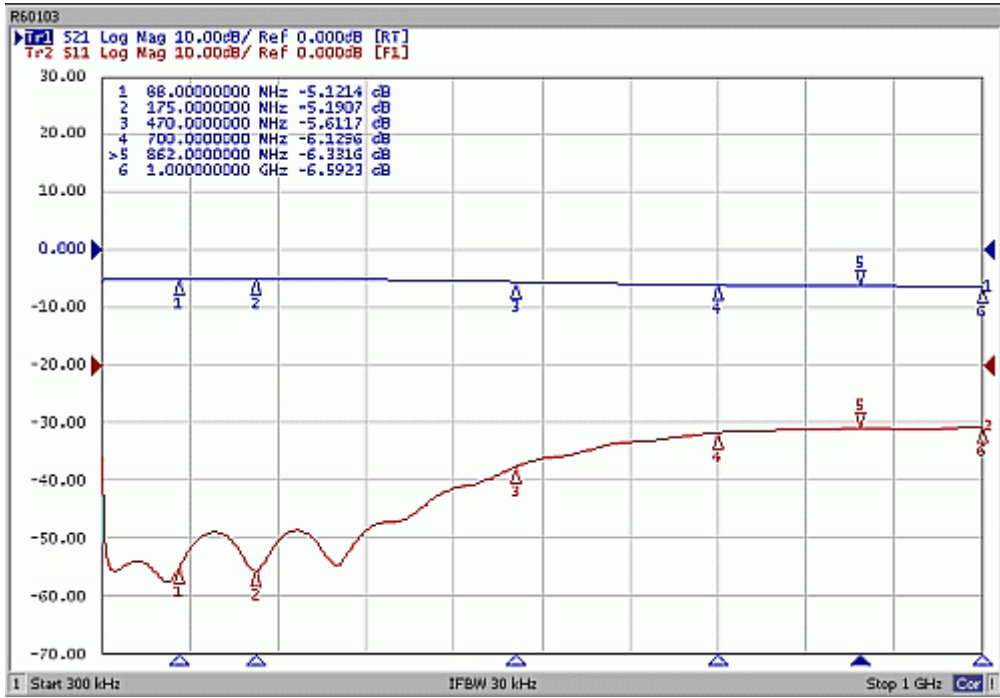

Loss and return loss diagram