

◆ MXN25C-HD Camera



◆ Features

- High resolution, Digital Color Camera
- HD CMOS camera (2.07 Mega pixels)
- Slim & Smart Design
- Easy adjustable in any viewing direction
- Auto White Balance
- WDR (Wide Dynamic Range)
- Automatic Electronic Iris
- LDC (Lens Distortion Correction)
- IP69K Waterproof Rating
- Main Viewing angle 130°, 160° or 180° Diagonally*
- Digital ZOOM ON/OFF function (via remote wire)
- Mirror Image (fixed image)
- Low-illumination
- Low Power Consumption
- Multi-purpose
(Frontview, sideview, rearview, surveillance, etc)
- Anti-corrosive coating
- Operating temperature -40°C to +80°C
- Vibration resistant (10G)
- Waterproof screw type connector, 4-pin mini-DIN.
- ECE R10.05 approved (EMC)

* Available models & main viewing angle per model:

| | |
|----------------------|--|
| MXN25C-HD-130 | 130° Diagonal, 105° Horizontal, 55° Vertical |
| MXN25C-HD-160 | 160° Diagonal, 130° Horizontal, 70° Vertical |
| MXN25C-HD-180 | 180° Diagonal, 180° Horizontal, 87° Vertical |

◆ Contents

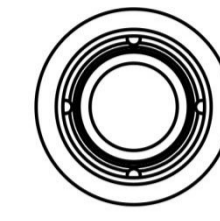

Camera x 1

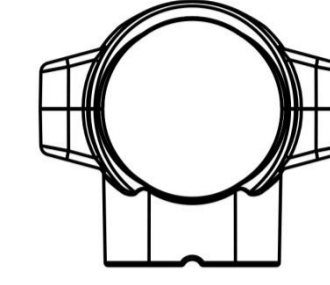

Camera Bracket x 1

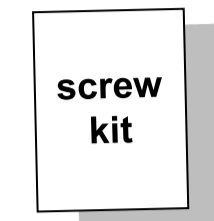

Screw kit x 1

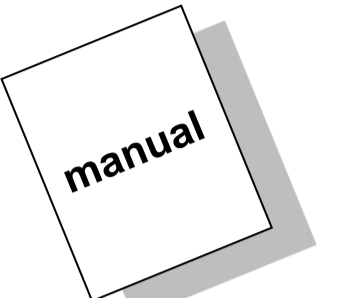

Manual x 1

◆ Technical Specifications

| | | |
|--|---|--|
| Image Sensor | 1/2.8" Sony CMOS Sensor (Exmor) | |
| Effective Pixels | 2.07 Mega pixels, 1920(H) x 1080(V) | |
| Resolution | 750 TV lines | |
| Synchronizing System | Internal | |
| Video Output | PAL, CVBS, 75 Ohms, 1.0Vp-p | |
| Audio Input | High Sensitive C-Microphone | |
| S/N Ratio | More than 48dB | |
| Minimum Illumination | 0.5 Lux | |
| Power Consumption | DC 12V, 100mA | |
| Power Range | DC 9V ~ DC 32V | |
| Operating Temperature | -40°C to +80°C | |
| Dimensions | Approx. Φ 30 mm, 48.6(W) x 42.32(D) x 39.92(H) incl. Bracket | |
| Weight | Approx. 70g | |
| Viewing Angle during activated Zoom function | MXN25C-HD-130 | 64° Diagonal, 50° Horizontal, 40° Vertical |
| | MXN25C-HD-160 | 48° Diagonal, 39° Horizontal, 32° Vertical |
| | MXN25C-HD-180 | 42° Diagonal, 32.5° Horizontal, 27° Vertical |

◆ Installation

■ Camera Assembly

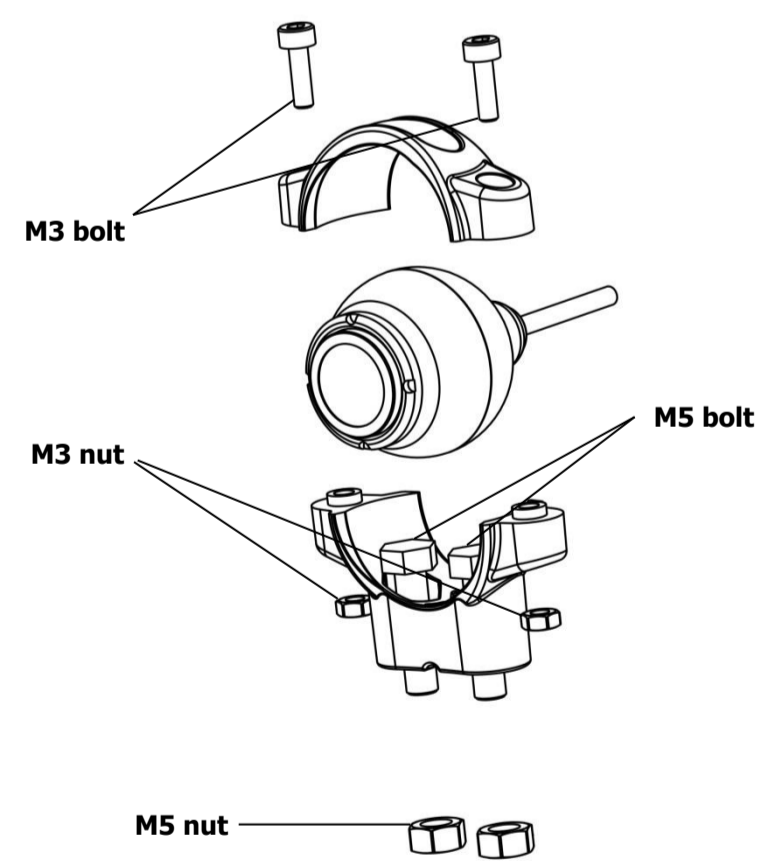

1. Fix the supplied camera bracket to the vehicle.
2. Fix the bracket with camera according to drawing.
3. Adjust the viewing angle of the camera and fasten the screws firmly.

■ Cable grommet

Drill a suitable hole (approx. Ø 19mm) and insert the cable grommet.
Just before final fixation, please apply a proper sealant (for prevention) between the hole and the grommet and also between the cable and the grommet.

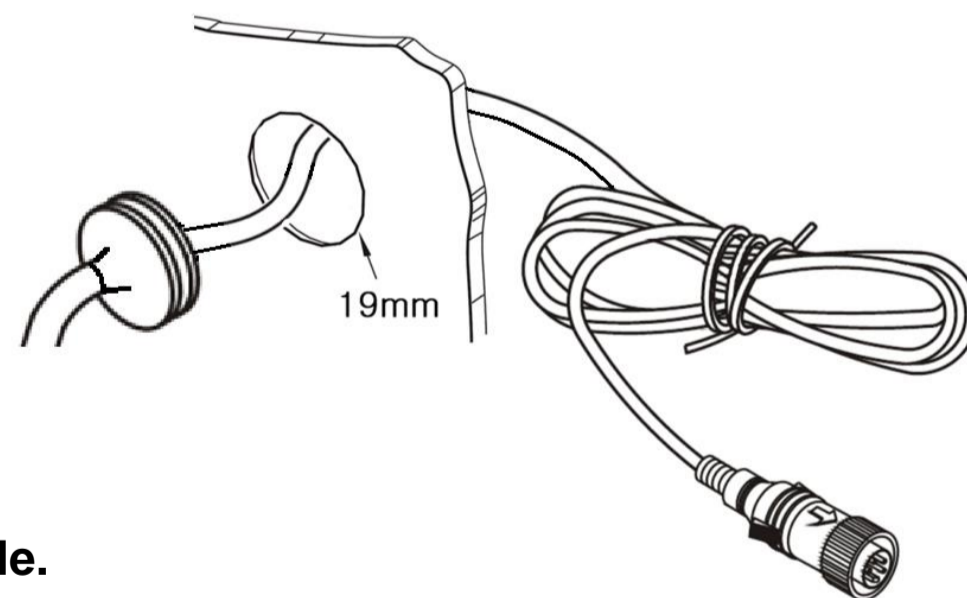

■ Securing cable connection

1. Match the arrow marks and press the connectors together.
2. Screw the camera connector up clockwise.



3. Tighten cable connection firmly in order to prevent water ingress.

Note!
Warranty will not be valid if the problem is related to moist / corrosion in the connector.

■ Wiring to Monitor

Run the cable from the camera to the monitor.

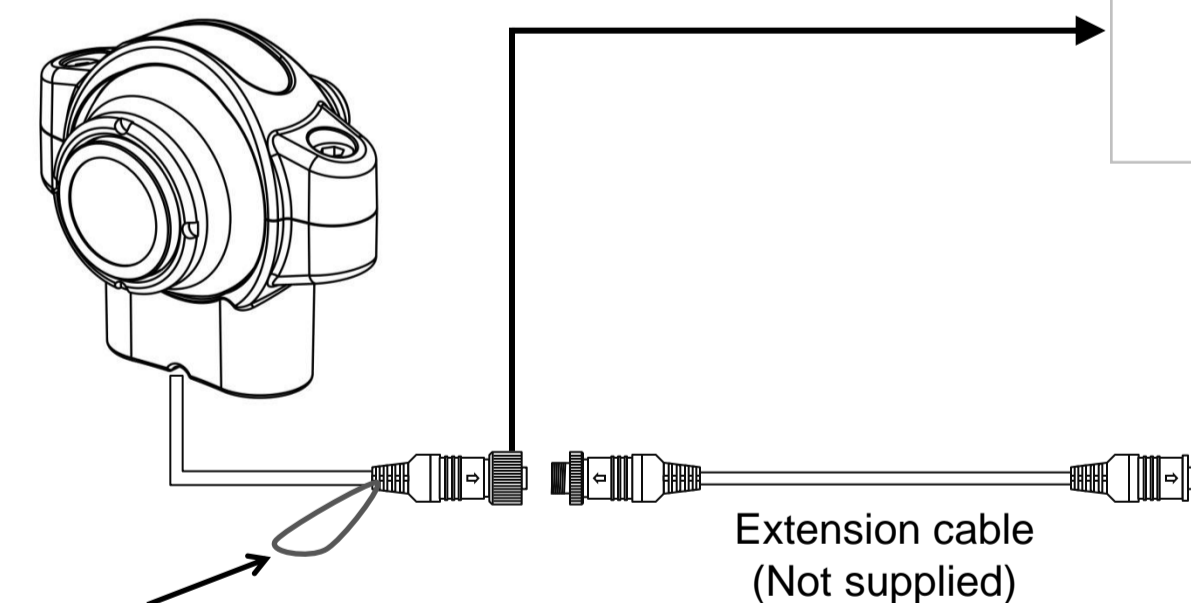

Camera pin configuration



■ Selectable Zoom function

The Zoom function can be controlled via the GREEN loop wire:

- * Green loop wire un-cut : Full image (Zoom function => OFF)
- * Green loop wire cut : Zoom image (Zoom function => ACTIVATED)

■ Caution !!

1. Before making the connection, disconnect the ground terminal from the battery to avoid short circuits.
2. The plugs should be fully inserted into the connectors or jacks. A loose connection may cause malfunctioning of the unit.
3. A damaged cable may affect the operation of the camera and may even cause a malfunction of the camera or monitor: Avoid a damaged cable!
4. Protect the cable by using a guide tube, pipe or run the cable inside the vehicle as much as possible. Caution! Run the cable in natural shapes in order to prevent cable breaks.
5. Preferably use an acid free grease in between the waterproof screw type connectors and tighten them firmly each other.